

Arnolds | Keys



96 The Street, Rockland St. Mary, Norwich, NR14 7HQ

£1,525 Per Calendar Month

- Four Bedrooms
- Dining Room
- Cloakroom and Utility Room
- Council Tax Band: E - South Norfolk
- Detached
- Conservatory
- Family Bathroom and Ensuite Shower Room
- Living Room with open fireplace
- Fitted Kitchen with Stoves Double Electric Oven
- EPC Rating: C

25 King Street, Norwich, Norfolk, NR1 1PD
01603 216812

lettings@arnoldskeys.com
www.arnoldskeys.com

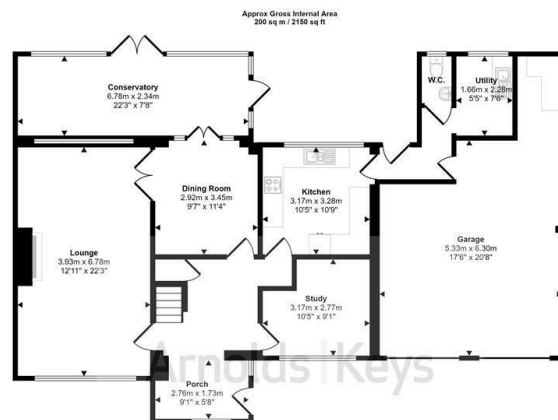

Ground Floor
Approx 134 sq m / 1442 sq ft

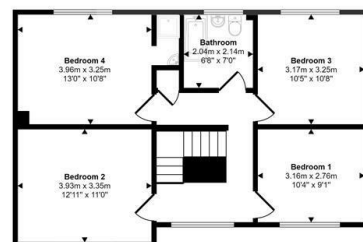

First Floor
Approx 66 sq m / 708 sq ft

This floorplan is only for illustrative purposes and is not to scale. Measurements of rooms, doors, windows, and any items are approximate and no responsibility is taken for any error, omission or misstatement. Some of items such as bathroom suites are representations only and may not look like the real items. Made with Made Snappy 360.

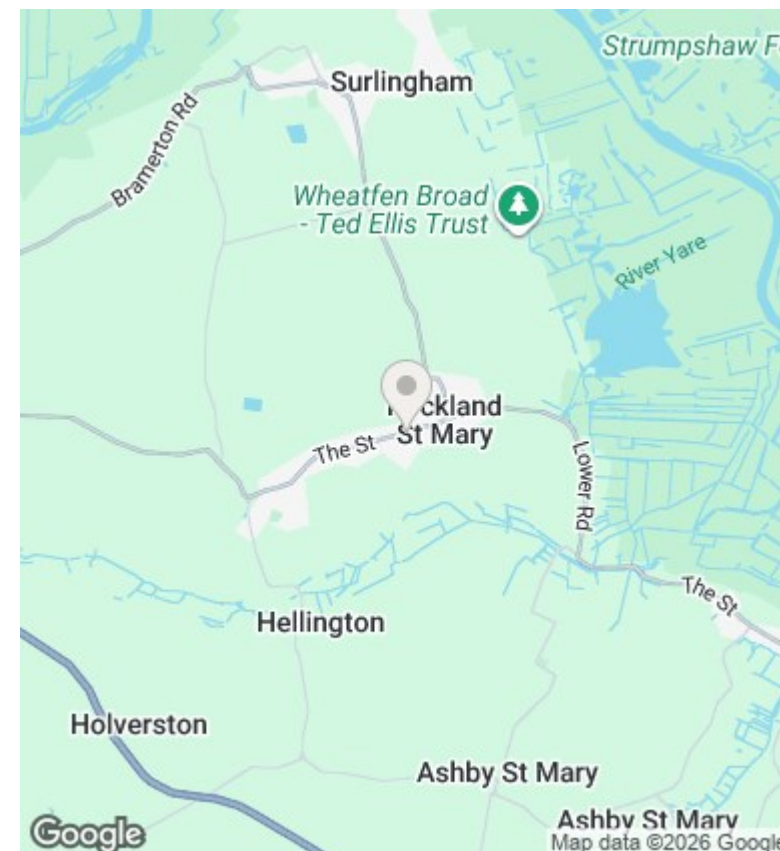

Directions

Viewings

Viewings by arrangement only. Call 01603 216812 to make an appointment.

Council Tax Band

E

EPC Rating:

C

Energy Efficiency Rating		
	Current	Potential
Very energy efficient - lower running costs		
(92 plus) A		
(81-91) B		
(69-80) C		
(55-68) D		
(39-54) E		
(21-38) F		
(1-20) G		
Not energy efficient - higher running costs		
England & Wales	EU Directive 2002/91/EC	

25 King Street, Norwich, Norfolk, NR1 1PD
01603 216812

lettings@arnoldskeys.com
www.arnoldskeys.com